

T-241 HIGH PURITY PRESSURE REGULATOR



TECHNICAL SPECIFICATION:

Size range:	1/2" - 2-1/2" (20 mm - 75 mm)
Body Material:	PVDF-HP
Bonnet Material:	PP-White
Diaphragm:	PTFE with EPDM backing
End Connections:	Metric (DIN) spigot SDR21

FEATURES:

- High purity PVDF and PTFE are the only wetted materials
- Pressure gauge isolated from media
- Stainless steel gauge material
- May be installed in any position
- Setpoint may be adjusted while valve is under pressure

OPERATING PARAMETERS:

Max Pressure: 150psi (1/2" - 2"); 90psi (2-1/2")

Temperature: -4° F to 212° F

Outlet Range: 22psi to 131psi

- Controls downstream pressure at a constant set point
- As input fluctuates, the spring set force opens and closes the valve diaphragm to maintain a constant output pressure

SAMPLE SPECIFICATIONS:

All T-241 pressure regulating valves shall be made from virgin PVDF resin, utilize PTFE diaphragms, and shall be cleaned and double-bagged. 1/2" – 2" (20mm – 63mm) shall be pressure rated to 150psi at 68° F. 2-1/2" (75mm) shall be pressure rated to 90psi at 68° F. T-241 regulating valves shall have an integral gauge guard and allow for inline adjustments of the valve.

T-241 HIGH PURITY PRESSURE REGULATOR

DIMENSIONS:

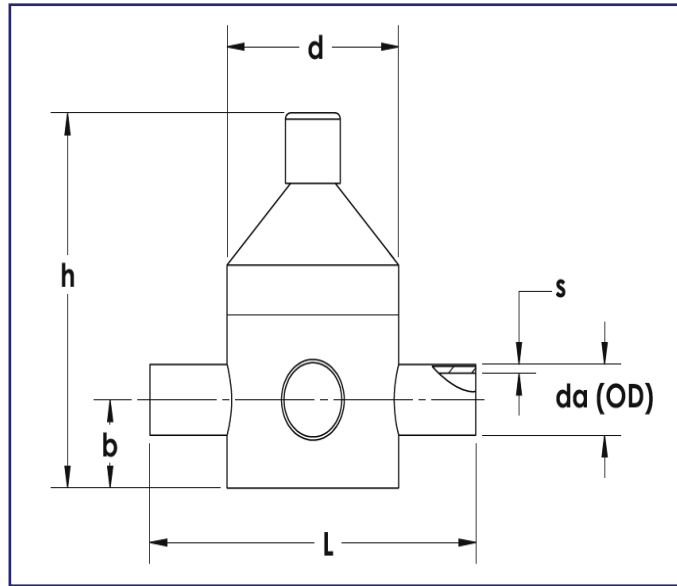

Size		Part Number	s (in)	L (in)	d (in)	h (in)	b (in)	Weight (lbs)
inch	mm							
1/2	20	540341005	0.075	5.91	2.76	5.12	1.18	2.27
3/4	25	540341007	0.075	7.48	3.94	6.69	1.57	3.69
1	32	540341010	0.094	7.48	3.94	6.69	1.57	3.58
1-1/4	40	540341012	0.094	9.45	5.12	9.06	2.17	8.66
1-1/2	50	540341015	0.118	9.45	5.12	9.06	2.17	8.50
2	63	540341020	0.118	10.24	6.10	11.22	2.95	11.58
2-1/2	75	540341025	0.142	11.81	7.48	13.78	3.94	29.35