



New Product Announcement

Aug. 2013

Product Development

Asahi/America is committed to continuously improving our product portfolio. Whether bringing on new products or shifting manufacturing domestically, we are dedicated to providing our customers with the best service.

Proven Products

Our Chem Proline® high density polyethylene (HDPE) chemical piping system is currently installed in numerous industrial applications across a wide assortment of industries.

Stock & Delivery

We feature a full selection of pipe and fittings in sizes from 1/2" - 12" in stock and ready for shipment. In addition we stock a full offering of welding tool available for purchase or rent.

**Another
Corrosion
Problem
Solved.™**

Chem Proline® Piping System

PVC/CPVC Chem Proline® Transition Union



Asahi/America has made transitioning from PVC or CPVC to our Chem Proline® piping system, simpler and quicker with the development of this new adapter union.

Instead of replacing a complete line because of system maintenance or failure from damage to PVC or CPVC chemical line, this new adapter allows you to replace just the compromised section without taking down the entire line.

Specifications

Material:	HDPE
Size Range:	1/2" to 2"
Pressure Range:	SDR11 at 150psi
Color:	Black



Part Numbers

Size	PVC	CPVC
1/2"	585827005	585828005
3/4"	585827007	585828007
1"	585827010	585828010
1-1/2"	585827015	585828015
2"	585827020	585828020

Dimensional Data

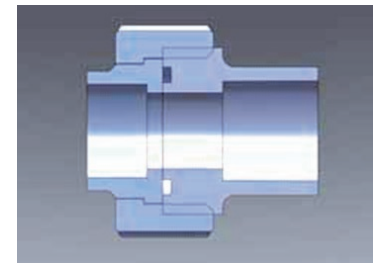
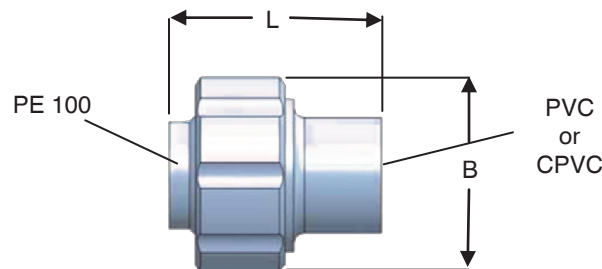

Pipe Size	L	B
1/2" (20mm)	2-1/4	1-3/4
3/4" (25mm)	2-3/8	2-1/8
1" (32mm)	2-1/2	2-1/2
1-1/2" (50mm)	3-1/2	3-3/8
2" (63mm)	3-5/8	4